



STATE OF NORTH CAROLINA  
DEPARTMENT OF TRANSPORTATION

ROY COOPER  
GOVERNOR

JAMES H. TROGDON, III  
SECRETARY

September 18, 2017

WBS No: 17BP.10.R.58  
Contract No: DJ00232  
County: Anson  
Description: Remove and Replace Bridge #86 over Cedar Creek with a Concrete Box Culvert.

**Addendum No. 1**

October 4, 2017 Letting

To: Prospective Bidders

Please note the following revisions to the proposal for the above referenced project.

- Please void the Proposal cover sheet and replace with the attached Addendum #1 Proposal cover sheet.
- Page 5 of the Table of Contents has been revised. Please void Page 5 of the Proposal and replace with Page 5 provided in Addendum #1.
- The **Temporary Pipe for Culvert Construction** provision has been deleted. Please void Page 80 of the Proposal and replace with Page 80 provided in Addendum #1.
- The Impervious Dike provision has been revised. Please void Page 83 of the Proposal and replace with Page 83 provided in Addendum #1.
- The **Contract Items** have been revised to delete the 54" TEMPORARY PIPE pay item and edit the IMPERVIOUS DIKE estimated quantity. Please void Pages 219 through 221 of the Proposal and replace with Pages 219 through 221 provided in Addendum #1.
- Please void Sheet EC-5 of the Roadway Plans and replace with the revised Sheet EC-5 dated 9-18-2017 provided with Addendum #1.

If you are submitting an electronic bid package you must go to the Division 10 Letting site and download and use the DJ00232.001 addendum file. The Division 10 Letting site can be accessed at the following link [https://connect.ncdot.gov/letting/Pages/Letting-Details.aspx?let\\_type=10&let\\_date=2017-10-04](https://connect.ncdot.gov/letting/Pages/Letting-Details.aspx?let_type=10&let_date=2017-10-04)

*Mailing Address:*  
NC DEPARTMENT OF TRANSPORTATION  
HIGHWAY DIVISION 10  
716 WEST MAIN ST.  
ALBEMARLE, NC 28001

*Telephone:* (704) 983-4400  
*Fax:* (704) 982-3146  
*Customer Service:* 1-877-368-4968

*Location:*  
716 WEST MAIN ST.  
ALBEMARLE, NC 28001

*Website:* [www.ncdot.gov](http://www.ncdot.gov)

If you have any questions, please contact me at (704) 983-4400.

Sincerely,

DocuSigned by:



5169D778708C4B7...

Terry Burleson  
Proposals Engineer

cc: Kellie Crump, Project Manager  
Garland Haywood, PE, Bridge Program Manager  
File

STATE OF NORTH CAROLINA  
DEPARTMENT OF TRANSPORTATION  
HIGHWAY DIVISION 10

## PROPOSAL

**Includes Addendum #1 - September 18, 2017**

**DATE AND TIME OF BID OPENING:** Wednesday October 4, 2017 AT 2:00 P.M.

**CONTRACT ID:** DJ00232

**WBS ELEMENT NO.:** 17BP.10.R.58

**FEDERAL AID NO.:** None

**COUNTY:** Anson

**TIP NO.:** None

**MILES:** 0.094

**LOCATION:** Bridge #86 on SR 1105 (Old Ruby SC Rd.)

**TYPE OF WORK:** Grading, Drainage, Paving and Structure

★ **AVAILABILITY DATE:** November 6, 2017 ★

**COMPLETION DATE:** November 29, 2018

**NOTICE:**

ALL BIDDERS SHALL COMPLY WITH ALL APPLICABLE LAWS REGULATING THE PRACTICE OF GENERAL CONTRACTING AS CONTAINED IN CHAPTER 87 OF THE GENERAL STATUTES OF NORTH CAROLINA WHICH REQUIRES THE BIDDER TO BE LICENSED BY THE N.C. LICENSING BOARD FOR CONTRACTORS WHEN BIDDING ON ANY NON-FEDERAL AID PROJECT WHERE THE BID IS \$30,000 OR MORE, EXCEPT FOR CERTAIN SPECIALTY WORK AS DETERMINED BY THE LICENSING BOARD. BIDDERS SHALL ALSO COMPLY WITH ALL OTHER APPLICABLE LAWS REGULATING THE PRACTICES OF ELECTRICAL, PLUMBING, HEATING AND AIR CONDITIONING AND REFRIGERATION CONTRACTING AS CONTAINED IN CHAPTER 87 OF THE GENERAL STATUTES OF NORTH CAROLINA. NOTWITHSTANDING THESE LIMITATIONS ON BIDDING, THE BIDDER WHO IS AWARDED ANY FEDERAL - AID FUNDED PROJECT SHALL COMPLY WITH CHAPTER 87 OF THE GENERAL STATUTES OF NORTH CAROLINA FOR LICENSING REQUIREMENTS WITHIN 60 CALENDAR DAYS OF BID OPENING.

**THIS IS A STRUCTURE PROJECT.**

**BID BONDS ARE REQUIRED.**

---

**NAME OF BIDDER**

---

**ADDRESS OF BIDDER**

COIR FIBER MAT:.....	79
TEMPORARY ROCK SILT CHECK TYPE A WITH EXCELSIOR MATTING AND POLYACRYLAMIDE: .....	81
IMPERVIOUS DIKE:.....	82
CONCRETE WASHOUT STRUCTURE: .....	83
<b>ENVIRONMENTAL PERMITS .....</b>	<b>85</b>
<b>SPECIAL PROVISIONS--STRUCTURE .....</b>	<b>150</b>
FALSWORK AND FORMWORK.....	151
CRANE SAFETY .....	157
GROUT FOR STRUCTURES.....	158
SUBMITTAL OF WORKING DRAWINGS .....	160
ASBESTOS ASSESSMENT FOR BRIDGE DEMOLITION AND RENOVATION ACTIVITIES .....	166
PLACEMENT OF NATIVE MATERIAL .....	168
STRUCTURE SUBSURFACE INVESTIGATION .....	170
<b>STANDARD SPECIAL PROVISIONS .....</b>	<b>183</b>
AVAILABILITY OF FUNDS – TERMINATION OF CONTRACTS .....	183
NCDOT GENERAL SEED SPECIFICATION FOR SEED QUALITY .....	183
ERRATA.....	186
PLANT AND PEST QUARANTINES.....	187
MINIMUM WAGES .....	188
AWARD OF CONTRACT .....	190
ON-THE-JOB TRAINING .....	196
NAME CHANGE FOR NCDENR: .....	199
<b>LETTER OF INTENT TO PERFORM AS A SUBCONTRACTOR.....</b>	<b>200</b>
<b>LISTING OF MBE/WBE SUBCONTRACTORS .....</b>	<b>201</b>
<b>SUBSTITUTE FORM W-9 .....</b>	<b>203</b>
<b>BID BOND.....</b>	<b>204</b>
<b>EXECUTION OF BID.....</b>	<b>211</b>
<b>DEBARMENT CERTIFICATION .....</b>	<b>217</b>
<b>CONTRACT ITEMS.....</b>	<b>219</b>
<b>ADDENDUM(S).....</b>	<b>222</b>

Place anchors across the mat at the ends approximately 1 ft. apart. Place anchors along the outer edges and down the center of the mat 3 ft. apart.

Adjustments in the trenching or anchoring requirements to fit individual site conditions may be required.

**Measurement and Payment**

*Coir Fiber Mat* will be measured and paid for as the actual number of square yards measured along the surface of the ground over which coir fiber mat is installed and accepted.

No measurement will be made for anchor items.

Payment will be made under:

<b>Pay Item</b>	<b>Pay Unit</b>
Coir Fiber Mat	Square Yard

**Measurement and Payment**

*Impervious Dike* will be measured and paid as the actual number of linear feet of impervious dike(s) constructed, measured in place from end to end of each separate installation that has been completed and accepted. Such price and payment will be full compensation for all work including but not limited to furnishing materials, construction, maintenance, and removal of the impervious dike. The pump around operation will be considered incidental to the *Impervious Dike* pay item.

Payment will be made under:

<b>Pay Item</b>	<b>Pay Unit</b>
Impervious Dike	Linear Foot

**CONCRETE WASHOUT STRUCTURE:**

(12-01-15)

**Description**

Concrete washout structures are enclosures above or below grade to contain concrete waste water and associated concrete mix from washing out ready-mix trucks, drums, pumps, or other equipment. Concrete washouts must collect and retain all the concrete washout water and solids, so that this material does not migrate to surface waters or into the ground water. These enclosures are not intended for concrete waste not associated with wash out operations.

The concrete washout structure may include constructed devices above or below ground and or commercially available devices designed specifically to capture concrete waste water.

**Materials**

<b>Item</b>	<b>Section</b>
Temporary Silt Fence	1605

*Safety Fence* shall meet the specifications as provided elsewhere in this contract.

Geomembrane basin liner shall meet the following minimum physical properties for low permeability; it shall consist of a polypropylene or polyethylene 10 mil thick geomembrane. If the minimum setback dimensions can be achieved the liner is not required. (5 feet above groundwater, 50 feet from top of bank of perennial stream, other surface water body, or wetland.)

**Construction Methods**

Build an enclosed earthen berm or excavate to form an enclosure in accordance with the details and as directed.

## CONTRACT ITEMS

Work Order No. WBS# 17BP.10.R.58

9/18/2017 Remove and Replace Bridge #86 Over Cedar Creek on SR 1105 (Old Ruby SC Road)

County Anson

LINE NO.	MASTER ITEM NO.	SEC. NO.	ITEM DESCRIPTION	ESTIMATED QUANTITY	UNIT	UNIT PRICE	TOTAL AMOUNT
1.	0000100000-N	800	MOBILIZATION	1	LS		
2.	0000400000-N	801	CONSTRUCTION SURVEYING	1	LS		
3.	0008000000-E	200	SUPPLEMENTARY CLEARING & GRUBBING	1	ACR		
4.	0057000000-E	226	UNDERCUT EXCAVATION	50	CY		
5.	0063000000-N	SP	GRADING	1	LS		
6.	0318000000-E	300	FOUNDATION CONDITIONING MATERIAL, MINOR STRUCTURES	5	TON		
7.	0320000000-E	300	FOUNDATION CONDITIONING GEOTEXTILE	10	SY		
8.	0366000000-E	310	15" RC PIPE CULVERTS, CLASS III	28	LF		
9.	1220000000-E	545	INCIDENTAL STONE BASE	65	TON		
10.	1330000000-E	607	INCIDENTAL MILLING	100	SY		
11.	1489000000-E	610	ASPHALT CONC BASE COURSE, TYPE B25.0B	441	TON		
12.	1525000000-E	610	ASPHALT CONC SURFACE COURSE, TYPE SF9.5A	188	TON		
13.	1575000000-E	620	ASPHALT BINDER FOR PLANT MIX	35	TON		
14.	3030000000-E	862	STEEL BM GUARDRAIL	250	LF		
15.	3045000000-E	862	STEEL BM GUARDRAIL, SHOP CURVED	43.75	LF		
16.	3150000000-N	862	ADDITIONAL GUARDRAIL POSTS	5	EA		
17.	3195000000-N	862	GUARDRAIL ANCHOR UNITS, TYPE AT-1	1	EA		
18.	3287000000-N	SP	GUARDRAIL END UNITS, TYPE TL-3	3	EA		
19.	3635000000-E	876	RIP RAP, CLASS II	95	TON		
20.	3649000000-E	876	RIP RAP, CLASS B	95	TON		
21.	3656000000-E	876	GEOTEXTILE FOR DRAINAGE	310	SY		
22.	4400000000-E	1110	WORK ZONE SIGNS (STATIONARY)	440.75	SF		
23.	4410000000-E	1110	WORK ZONE SIGNS (BARRICADE MOUNTED)	110	SF		
24.	4445000000-E	1145	BARRICADES (TYPE III)	64	LF		
25.	4835000000-E	1205	PAINT PAVEMENT MARKING LINES (24")	18	LF		
26.	6000000000-E	1605	TEMPORARY SILT FENCE	470	LF		
27.	6009000000-E	1610	STONE FOR EROSION CONTROL, CLASS B	150	TON		
28.	6012000000-E	1610	SEDIMENT CONTROL STONE	155	TON		
29.	6015000000-E	1615	TEMPORARY MULCHING	0.5	ACR		

30.	6018000000-E	1620	SEED FOR TEMPORARY SEEDING	100	LB		
31.	6021000000-E	1620	FERTILIZER FOR TEMPORARY SEEDING	0.5	TON		
32.	6024000000-E	1622	TEMPORARY SLOPE DRAINS	200	LF		
33.	6029000000-E	SP	SAFETY FENCE	100	LF		
34.	6030000000-E	1630	SILT EXCAVATION	120	CY		
35.	6036000000-E	1631	MATTING FOR EROSION CONTROL	390	SY		
36.	6037000000-E	SP	COIR FIBER MAT	100	SY		
37.	6042000000-E	1632	1/4" HARDWARE CLOTH	195	LF		
38.	6070000000-N	1639	SPECIAL STILLING BASINS	4	EA		
39.	6071020000-E	SP	POLYACRYLAMIDE (PAM)	45	LB		
40.	6084000000-E	1660	SEEDING & MULCHING	0.5	ACR		
41.	6087000000-E	1660	MOWING	0.5	ACR		
42.	6090000000-E	1661	SEED FOR REPAIR SEEDING	50	LB		
43.	6093000000-E	1661	FERTILIZER FOR REPAIR SEEDING	0.25	TON		
44.	6096000000-E	1662	SEED FOR SUPPLEMENTAL SEEDING	50	LB		
45.	6108000000-E	1665	FERTILIZER TOPDRESSING	0.25	TON		
46.	6111000000-E	SP	IMPERVIOUS DIKE	78	LF		
47.	6114500000-N	1667	SPECIALIZED HAND MOWING	10	MHR		
48.	6117000000-N	SP	RESPONSE FOR EROSION CONTROL	13	EA		
49.	6132000000-N	SP	CONCRETE WASHOUT STRUCTURE	1	EA		
			<b>STRUCTURE ITEMS</b>				
50.	8035000000-N	402	REMOVAL OF EXISTING STRUCTURE AT STA. 12+82.89 -L-	1	LS		
51.	8126000000-N	414	CULVERT EXCAVATION, STA 12+82.89 -L-	1	LS		
52.	8133000000-E	414	FOUNDATION CONDITIONING MATERIAL, BOX CULVERT	120	TON		
53.	8196000000-E	420	CLASS A CONCRETE (CULVERT)	195.1	CY		
54.	8245000000-E	425	REINFORCING STEEL (CULVERT)	24654	LB		
55.	8804000000-N	SP	PLACEMENT OF NATIVE MATERIAL	1	LS		
56.	8860000000-N	SP	ASBESTOS ASSESSMENT	1	LS		



<b>Total Bid for Project</b>	\$
------------------------------	----

<b>CONTRACTOR</b> _____ <b>ADDRESS</b> _____ _____  <b>Federal ID No.</b> _____ <b>Contr. License No.</b> _____ <b>Telephone No.</b> _____ <b>Vendor No.</b> _____ <b>Authorized Agent</b> _____ <b>Signature</b> _____ <b>Witness</b> _____ <b>Signature</b> _____	<div style="border: 1px solid black; width: 100%; height: 100%; display: flex; align-items: center; justify-content: center;"> <p style="text-align: center; margin: 0;"><b>CORPORATE SEAL</b></p> </div> <b>Title</b> _____ <b>Date</b> _____ <b>Title</b> _____ <b>Date</b> _____
--	---

# TRIPLE 12' X 7' RCBC CULVERT CONSTRUCTION SEQUENCE

1. INSTALL IMPERVIOUS DIKES UPSTREAM AND DOWNSTREAM OF THE PROPOSED CULVERT.
2. INSTALL PUMP AROUND OPERATION TO CARRY CLEAN WATER AROUND THE WORK AREA TO ALLOW FOR CULVERT CONSTRUCTION.
3. PROVIDE PUMP AND STILLING BASIN FOR DEWATERING THE WORK ZONE.
4. CONSTRUCT CULVERT INCLUDING WINGWALLS AND OUTLET STABILIZATION ASSOCIATED WITH THE BARRELS.
5. CONSTRUCT FLOODPLAIN BENCH WITH NATIVE BED MATERIAL AND STABILIZE BENCH FACE WITH CLASS 'II' RIP RAP.
6. REMOVE IMPERVIOUS DIKES, DEWATERING STATION, AND PUMP AROUND AFTER WORK AREA HAS BEEN STABILIZED.
7. REMOVE EROSION CONTROL DEVICES AND BEGIN ROADWAY IMPROVEMENTS.

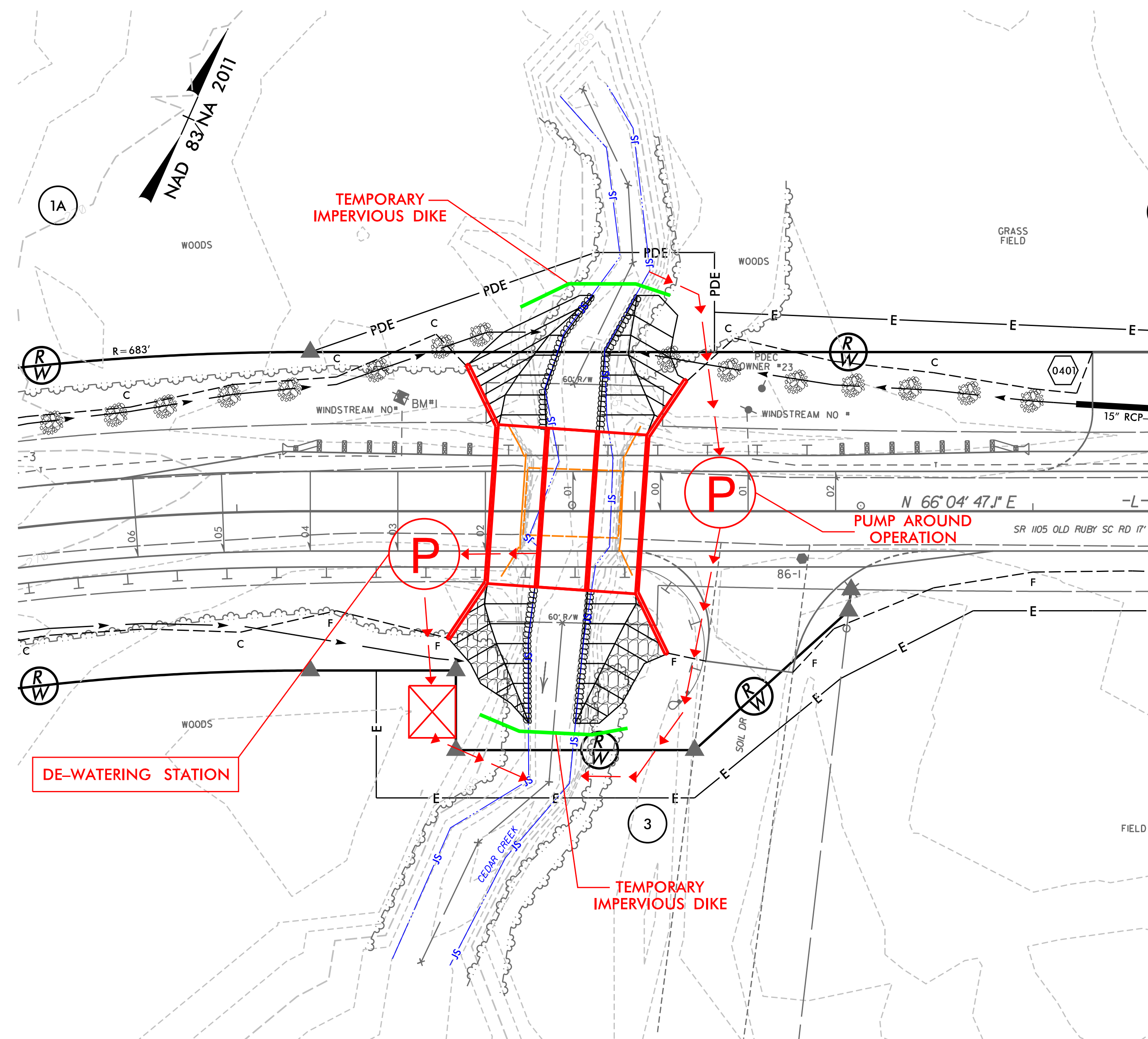

REVISION 9-18-2017: REVISED CONSTRUCTION SEQUENCE TO ELIMINATE TEMPORARY 54\" PIPE.